



BAE District

- Including Home Depot Area
- Resilient Green Commercial Corridor
- Concept of restructuring buyout areas to create a sustainable neighborhood
- Creates significant flood storage capacity and areas for mitigation





BAE Site





BAE Site



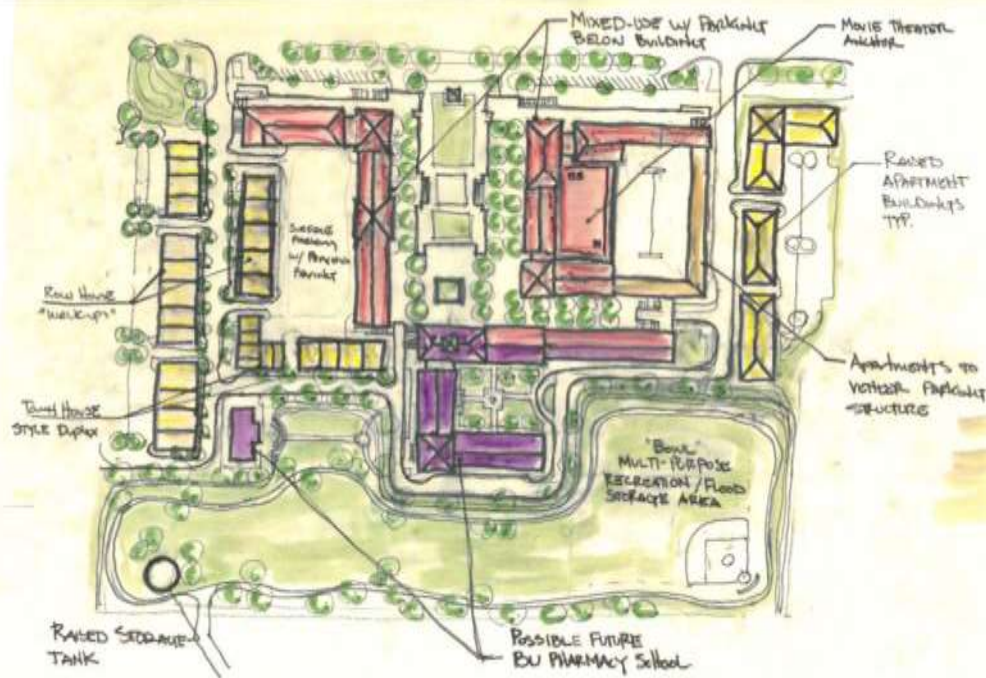

Concept 3



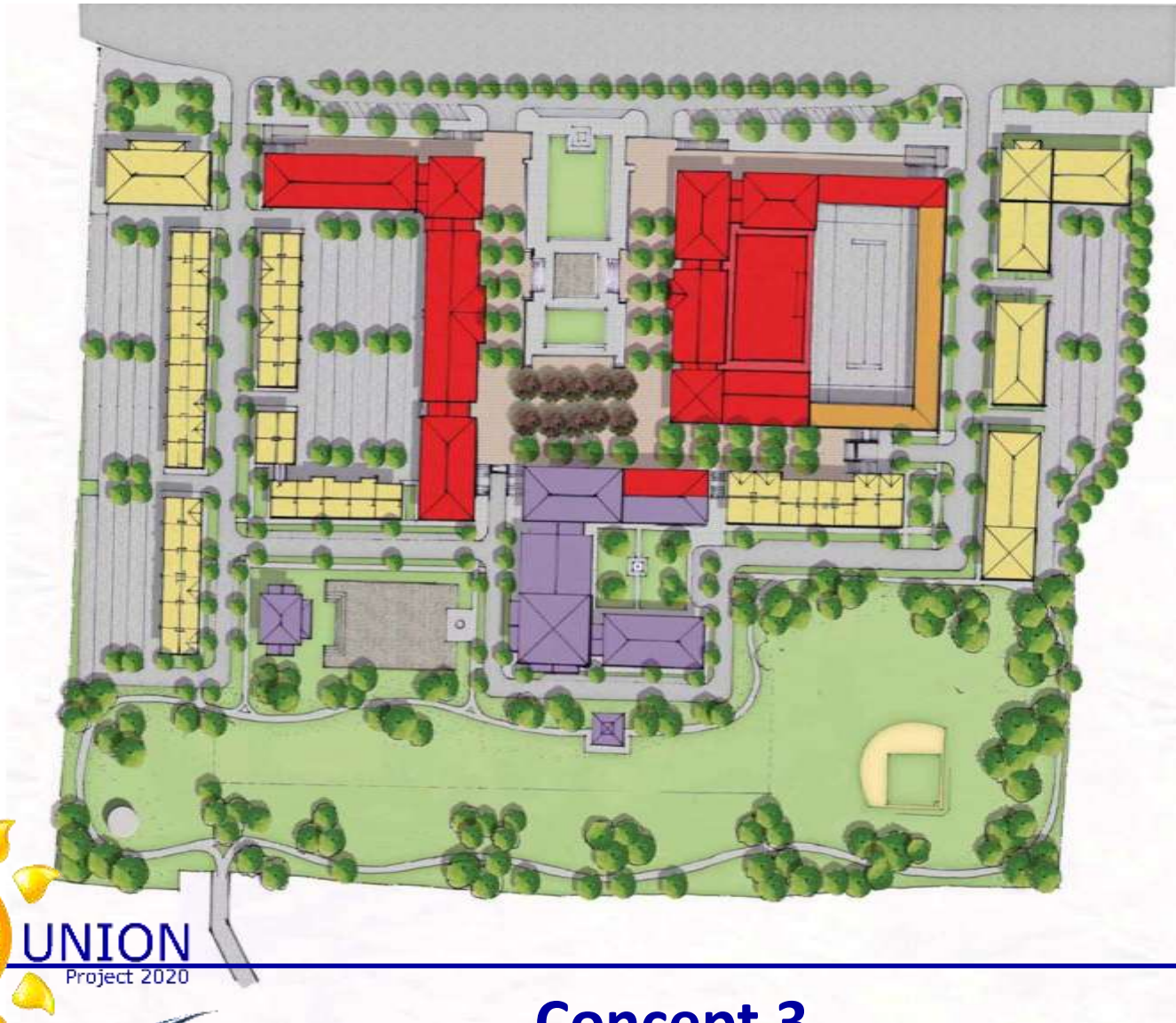

Concept 3





Pedestrian Friendly Mixed Use Center





Potential Future Satellite Campus



Mix of Flood Resilient Housing Types





Recreation / Flood Storage





Concept 3





Concept 3





Concept 3





Concept 3





Mall Site

- Big picture example showing “kitchen sink” of green infrastructure techniques
 - Bio Retention
 - Permeable Pavement
 - Grass Pavement
 - Underground Storage
 - Green Roof
 - Solar Roof
- Goal: Onsite capture of all stormwater









Gander Mountain Site

- Desirable commercial site
- Plan to gain significant flood storage capacity
- Linkages to other parcels and connection to Law the clover leafs and surrounding areas to store water in existing wetlands and new areas to be created
- Possible linkage to existing ball field and rec campus





